

PSM204.913  
 E: 505792.285  
 N: 7041641.909  
 RL: 11.093m

David John Connell being a Cadastral Surveyor and duly authorised representative of RPS AAP CONSULTING Pty. Ltd.  
 hereby :-  
 • certify the information contained in this drawing is an accurate "as-constructed" representation of the works.  
 • accept responsibility for the location of the "as-constructed" information contained in this drawing.  
 • acknowledge the "as-constructed" information contained in the drawing may be relied on by Council and others.  
 Certification for Stages HARMONY RELEASE 26A by [Signature] on 07.12.2023 (stage no.) (signature) (date)  
 for RPS AAP CONSULTING Pty. Ltd.

**Daniel Gibson** ENGINEERS CERTIFICATION  
 I hereby certify that:  
 1. The information contained in this drawing / document is in compliance with approved drawings and design.  
 2. The new water and sewerage works defined by this drawing have been designed and constructed in accordance with the SEQ code.  
 3. This represents an accurate record of as-constructed works.  
 4. I accept responsibility for the information contained in this drawing / document. In accepting this responsibility we have relied upon information provided by others.  
 CERTIFICATION FOR HARMONY RELEASE 26A  
 RPEQ Signature [Signature] RPEQ No. 23875 Date 08-12-2023  
 For and on behalf of EGIS CONSULTING PTY LTD.

- LEGEND**
- EX\_W --- EXISTING WATER MAIN
  - WATER MAIN (DN100 PVC-0 PN16)
  - WATER MAIN (DN100 PVC-0 PN20)
  - WATER MAIN (OD125 PE-100 PN16)
  - WATER MAIN (DN200 PVC-0 PN16)
  - WATER MAIN (DN200 PVC-0 PN20)
  - WATER MAIN (DN250 PE-100 PN16)
  - SERVICE PIPE (OD25 PE-100 PN16)
  - CONDUIT PIPE (DN100 PVC-U PN9)
  - WM WATER METER - 20mm ITRON
  - FH FIRE HYDRANT
  - TEE TEE
  - RT READY TAP
  - BEND BEND
  - END END CAP
  - CONN CONNECTOR
  - SV STOP/GATE VALVE

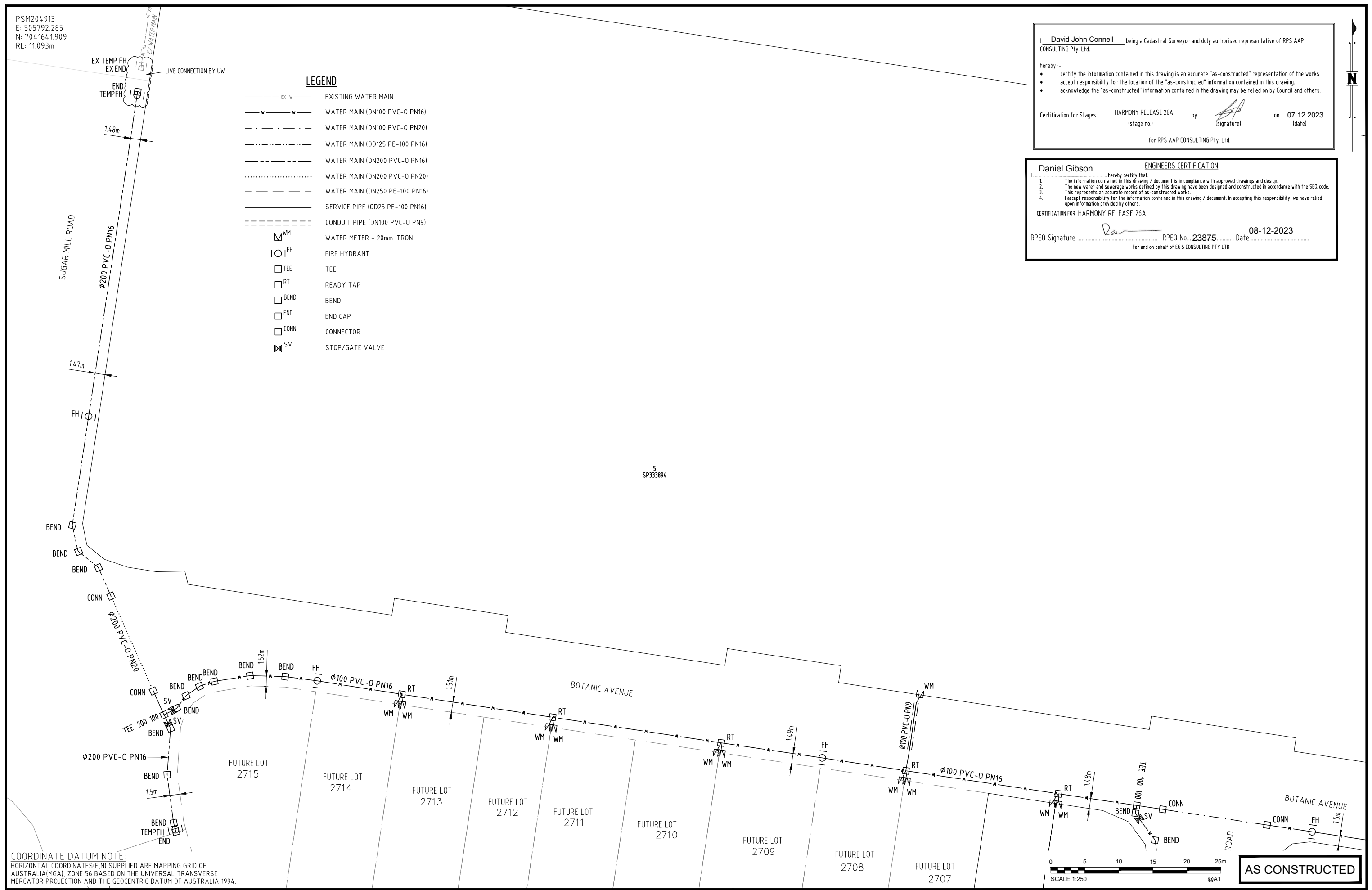

**COORDINATE DATUM NOTE:**  
 HORIZONTAL COORDINATES(E,N) SUPPLIED ARE MAPPING GRID OF AUSTRALIA(MGA), ZONE 56 BASED ON THE UNIVERSAL TRANSVERSE MERCATOR PROJECTION AND THE GEOCENTRIC DATUM OF AUSTRALIA 1994.

SCALE 1:250 @A1  
**AS CONSTRUCTED**

A1	0	31/10/2023	AS CONSTRUCTED DETAILS	LG	BS	
	INDEX	DATE	REVISIONS	DRAWN	CHECKED	PASSED

DRAWN	LG	31/10/2023
CHECKED	BS	31/10/2023
PASSED		
INITIALS	DATE	

**egis**  
 EGIS CONSULTING Pty Ltd  
 Level 4, Unit 401, 8 Market Lane,  
 Maroochydore, QLD 4558  
 Telephone 07 5314 2520  
 Facsimile 07 5314 2522

**Unitywater**

**Unitywater**  
 202202168952  
 HARMONY RELEASE 26A  
 AS CONSTRUCTED  
 WATER SUPPLY

SHEET 1 OF 10 SHEETS	SCALE 1:250
REVISION DATE 31/10/2023	REVISION 0
DISCIPLINE CODE C	
DRAWING NO. U-2023-4830	

PSM204.913  
E: 505792.285  
N: 704164.1909  
RL: 11.093m

**LEGEND**

---	EXISTING WATER MAIN
---	WATER MAIN (DN100 PVC-O PN16)
---	WATER MAIN (DN100 PVC-O PN20)
---	WATER MAIN (OD125 PE-100 PN16)
---	WATER MAIN (DN200 PVC-O PN16)
---	WATER MAIN (DN250 PVC-O PN20)
---	WATER MAIN (DN250 PE-100 PN16)
---	SERVICE PIPE (OD25 PE-100 PN16)
---	CONDUIT PIPE (DN100 PVC-U PN9)
WM	WATER METER - 20mm ITRON
FH	FIRE HYDRANT
TEE	TEE
RT	READY TAP
BEND	BEND
END	END CAP
CONN	CONNECTOR
SV	STOP/GATE VALVE

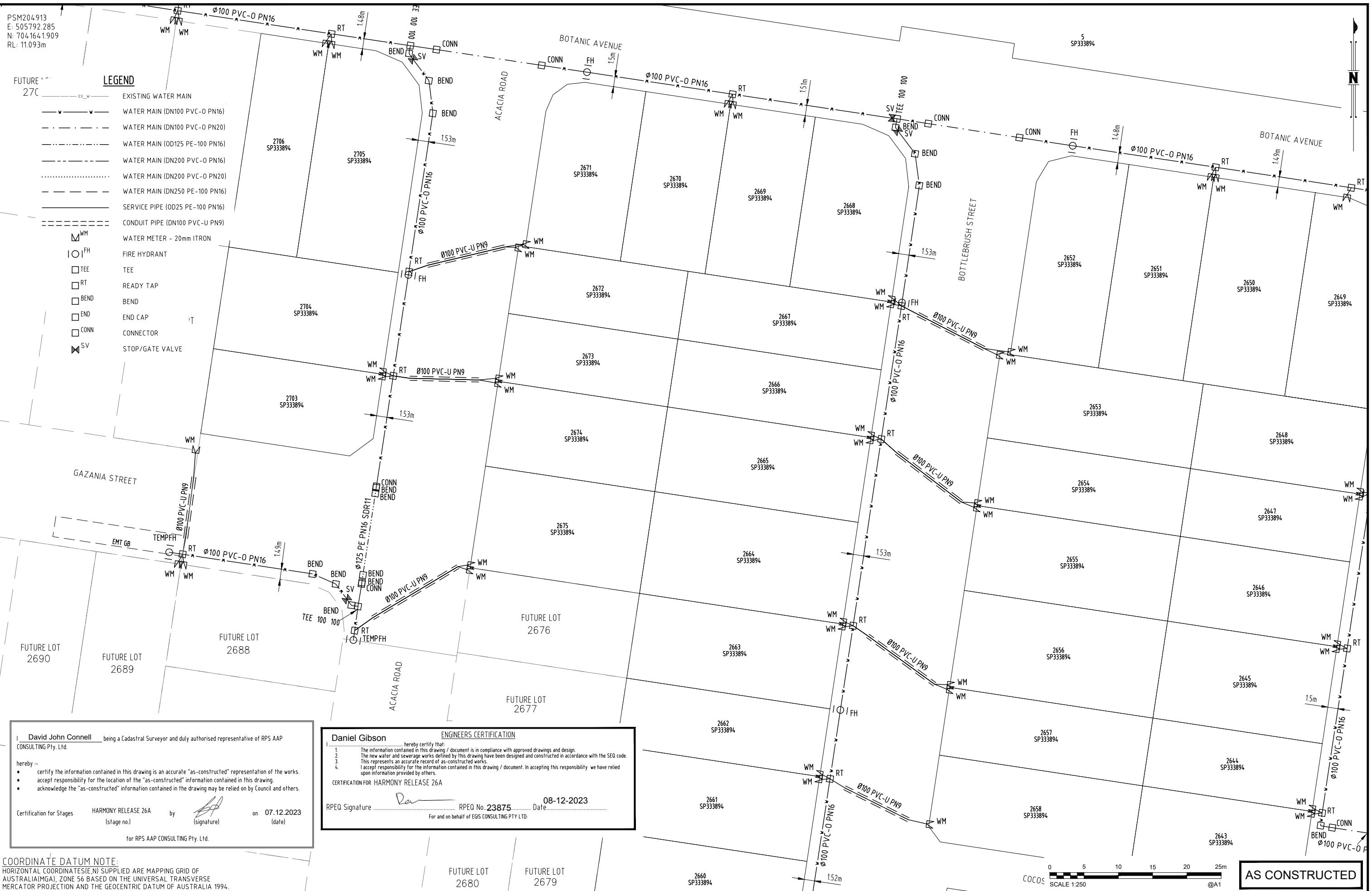

David John Connell being a Cadastral Surveyor and duly authorised representative of RPS AAP CONSULTING Pty. Ltd.

hereby -

- certify the information contained in this drawing is an accurate "as-constructed" representation of the works.
- accept responsibility for the location of the "as-constructed" information contained in this drawing.
- acknowledge the "as-constructed" information contained in the drawing may be relied on by Council and others.

Certification for Stages HARMONY RELEASE 26A by [Signature] on 07.12.2023 (stage no.) (signature) (date)

for RPS AAP CONSULTING Pty. Ltd.

**Daniel Gibson** ENGINEERS CERTIFICATION

I hereby certify that:

- The information contained in this drawing / document is in compliance with approved drawings and design.
- The new water and sewerage works defined by this drawing have been designed and constructed in accordance with the SEQ code.
- This represents an accurate record of as-constructed works.
- I accept responsibility for the information contained in this drawing / document. In accepting this responsibility we have relied upon information provided by others.

CERTIFICATION FOR HARMONY RELEASE 26A

RPEQ Signature [Signature] RPEQ No. 23875 Date 08-12-2023

For and on behalf of EGIS CONSULTING PTY LTD.

**COORDINATE DATUM NOTE:**  
HORIZONTAL COORDINATES(E,N) SUPPLIED ARE MAPPING GRID OF AUSTRALIA(MGA), ZONE 56 BASED ON THE UNIVERSAL TRANSVERSE MERCATOR PROJECTION AND THE GEOCENTRIC DATUM OF AUSTRALIA 1994.

SCALE 1:250 @A1

**AS CONSTRUCTED**

A1	0	31/10/2023	AS CONSTRUCTED DETAILS	LG	BS	PASSED
	INDEX	DATE	REVISIONS	DRAWN	CHECKED	PASSED

DRAWN	LG	31/10/2023
CHECKED	BS	31/10/2023
PASSED		
INITIALS	DATE	



**Unitywater**

202202168952  
HARMONY RELEASE 26A  
AS CONSTRUCTED  
WATER SUPPLY

SHEET 2 OF 10 SHEETS	SCALE 1:250
REVISION DATE 31/10/2023	REVISION 0
DISCIPLINE CODE C	
DRAWING NO. U-2023-4830	

PSM204.913  
 E: 505792.285  
 N: 7041641.909  
 RL: 11.093m

David John Connell being a Cadastral Surveyor and duly authorised representative of RPS AAP CONSULTING Pty. Ltd.

- hereby :-
- certify the information contained in this drawing is an accurate "as-constructed" representation of the works.
  - accept responsibility for the location of the "as-constructed" information contained in this drawing.
  - acknowledge the "as-constructed" information contained in the drawing may be relied on by Council and others.

Certification for Stages HARMONY RELEASE 26A (stage no.) by [Signature] on 07.12.2023 (date)  
 for RPS AAP CONSULTING Pty. Ltd.

Daniel Gibson ENGINEERS CERTIFICATION

- hereby certify that:
- The information contained in this drawing / document is in compliance with approved drawings and design.
  - The new water and sewerage works defined by this drawing have been designed and constructed in accordance with the SED code.
  - This represents an accurate record of as-constructed works.
  - I accept responsibility for the information contained in this drawing / document. In accepting this responsibility we have relied upon information provided by others.

CERTIFICATION FOR HARMONY RELEASE 26A

RPEQ Signature [Signature] RPEQ No. 23875 Date 08-12-2023  
 For and on behalf of EGIS CONSULTING PTY LTD.

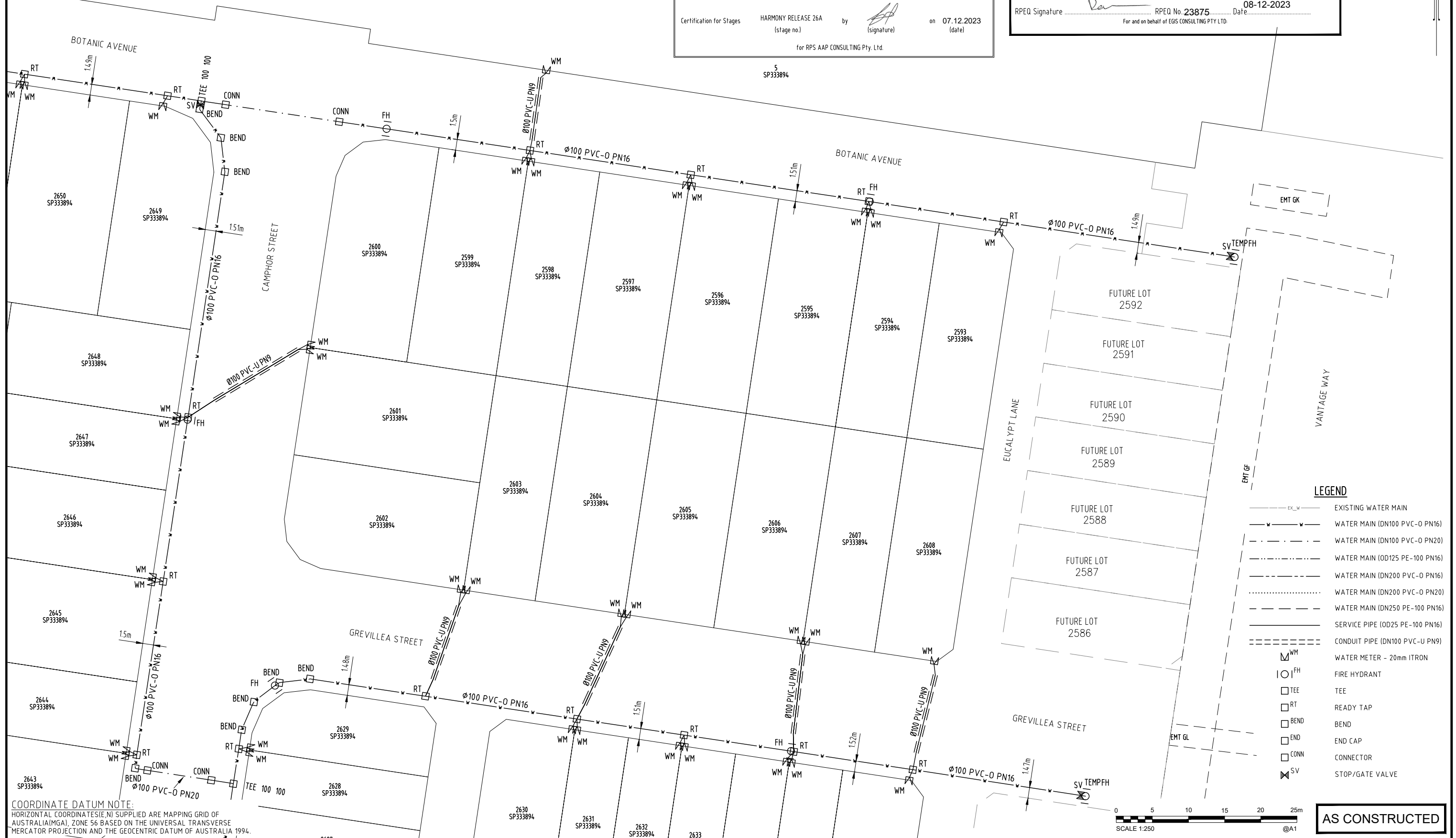

LEGEND

- EX\_W EXISTING WATER MAIN
- WATER MAIN (DN100 PVC-O PN16)
- WATER MAIN (DN100 PVC-O PN20)
- WATER MAIN (OD125 PE-100 PN16)
- WATER MAIN (DN200 PVC-O PN16)
- WATER MAIN (DN200 PVC-O PN20)
- WATER MAIN (DN250 PE-100 PN16)
- SERVICE PIPE (OD25 PE-100 PN16)
- CONDUIT PIPE (DN100 PVC-U PN9)
- WM WATER METER - 20mm ITRON
- FH FIRE HYDRANT
- TEE TEE
- RT READY TAP
- BEND BEND
- END END CAP
- CONN CONNECTOR
- SV STOP/GATE VALVE

COORDINATE DATUM NOTE:  
 HORIZONTAL COORDINATES (E, N) SUPPLIED ARE MAPPING GRID OF AUSTRALIA (MGA), ZONE 56 BASED ON THE UNIVERSAL TRANSVERSE MERCATOR PROJECTION AND THE GEOCENTRIC DATUM OF AUSTRALIA 1994.

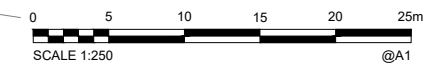

AS CONSTRUCTED

A1	0	31/10/2023	AS CONSTRUCTED DETAILS	LG	BS	
	INDEX	DATE	REVISIONS	DRAWN	CHECKED	PASSED

DRAWN	LG	31/10/2023
CHECKED	BS	31/10/2023
PASSED		
INITIALS	DATE	

EGIS CONSULTING Pty Ltd  
 Level 4, Unit 401, 8 Market Lane,  
 Maroochydore, QLD 4558  
 Telephone 07 5314 2520  
 Facsimile 07 5314 2522

Unitywater  
 202202168952  
 HARMONY RELEASE 26A  
 AS CONSTRUCTED  
 WATER SUPPLY

SHEET 3 OF 10 SHEETS	SCALE 1:250
REVISION DATE 31/10/2023	REVISION 0
DISCIPLINE CODE C	
DRAWING NO. U-2023-4830	

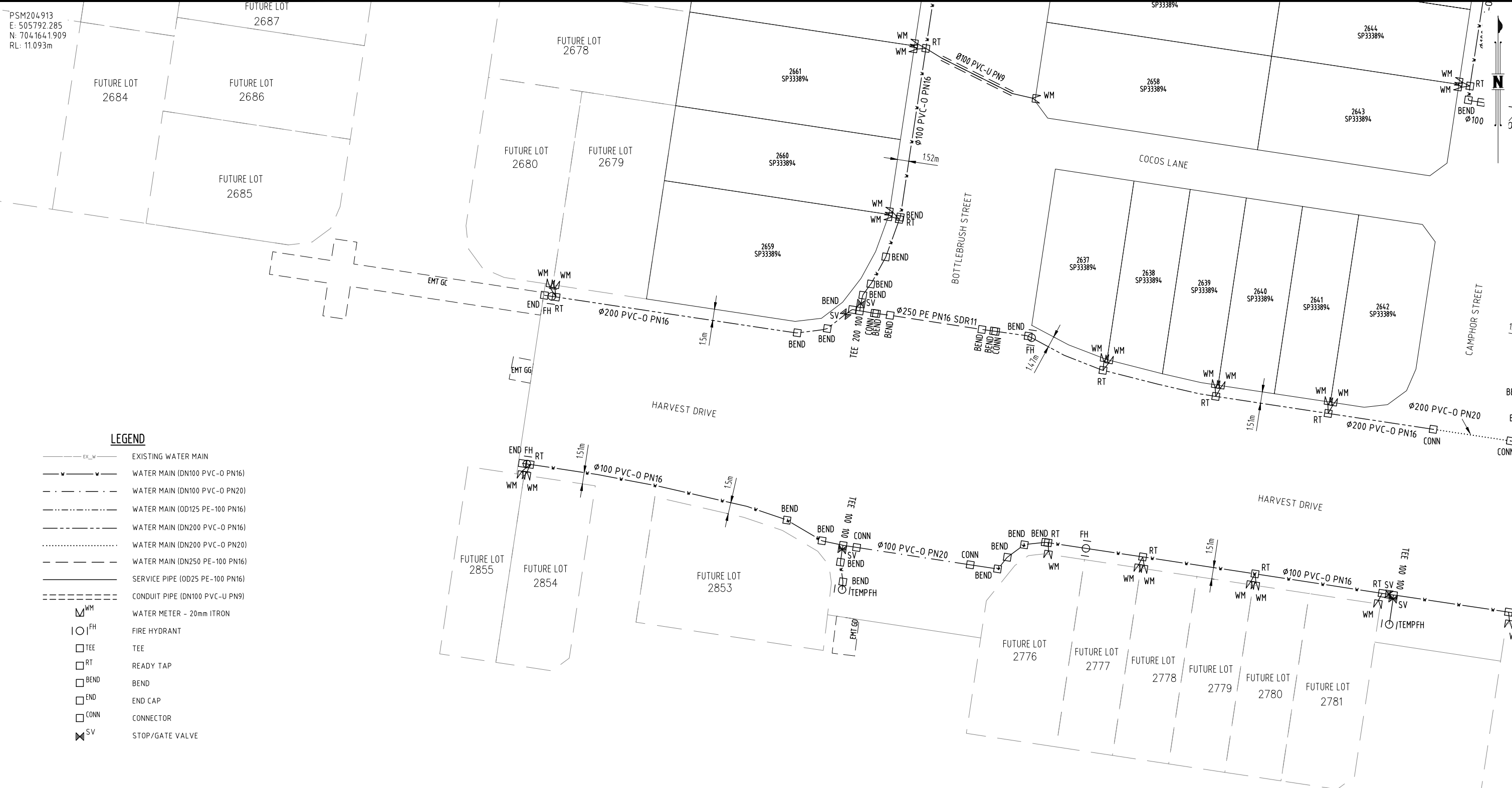

**LEGEND**

- EX\_W — EXISTING WATER MAIN
- WATER MAIN (DN100 PVC-O PN16)
- WATER MAIN (DN100 PVC-O PN20)
- WATER MAIN (OD125 PE-100 PN16)
- WATER MAIN (DN200 PVC-O PN16)
- WATER MAIN (DN200 PVC-O PN20)
- WATER MAIN (DN250 PE-100 PN16)
- SERVICE PIPE (OD25 PE-100 PN16)
- CONDUIT PIPE (DN100 PVC-U PN9)
- WM WATER METER - 20mm ITRON
- FH FIRE HYDRANT
- TEE TEE
- RT READY TAP
- BEND BEND
- END END CAP
- CONN CONNECTOR
- SV STOP/GATE VALVE

**David John Connell** being a Cadastral Surveyor and duly authorised representative of RPS AAP CONSULTING Pty. Ltd.

hereby -

- certify the information contained in this drawing is an accurate "as-constructed" representation of the works.
- accept responsibility for the location of the "as-constructed" information contained in this drawing.
- acknowledge the "as-constructed" information contained in the drawing may be relied on by Council and others.

Certification for Stages HARMONY RELEASE 26A by *[Signature]* on 07.12.2023 (stage no.) (signature) (date)

for RPS AAP CONSULTING Pty. Ltd.

**ENGINEERS CERTIFICATION**

**Daniel Gibson** hereby certify that:

1. The information contained in this drawing / document is in compliance with approved drawings and design.
2. The new water and sewerage works defined by this drawing have been designed and constructed in accordance with the SEQ code.
3. This represents an accurate record of as-constructed works.
4. I accept responsibility for the information contained in this drawing / document. In accepting this responsibility we have relied upon information provided by others.

CERTIFICATION FOR HARMONY RELEASE 26A

RPEQ Signature *[Signature]* RPEQ No. 23875 Date 08-12-2023

For and on behalf of EGIS CONSULTING PTY LTD.

**COORDINATE DATUM NOTE:**  
 HORIZONTAL COORDINATES(E,N) SUPPLIED ARE MAPPING GRID OF AUSTRALIA(MGA), ZONE 56 BASED ON THE UNIVERSAL TRANSVERSE MERCATOR PROJECTION AND THE GEOCENTRIC DATUM OF AUSTRALIA 1994.

0 5 10 15 20 25m  
 SCALE 1:250 @A1

**AS CONSTRUCTED**

A1	0	31/10/2023	AS CONSTRUCTED DETAILS	LG	BS	
	INDEX	DATE	REVISIONS	DRAWN	CHECKED	PASSED

DRAWN	LG	31/10/2023
CHECKED	BS	31/10/2023
PASSED		
INITIALS	DATE	



**Unitywater**

202202168952  
 HARMONY RELEASE 26A  
 AS CONSTRUCTED  
 WATER SUPPLY

SHEET 4 OF 10 SHEETS	SCALE 1:250
REVISION DATE 31/10/2023	REVISION 0
DISCIPLINE CODE C	
DRAWING NO. U-2023-4830	



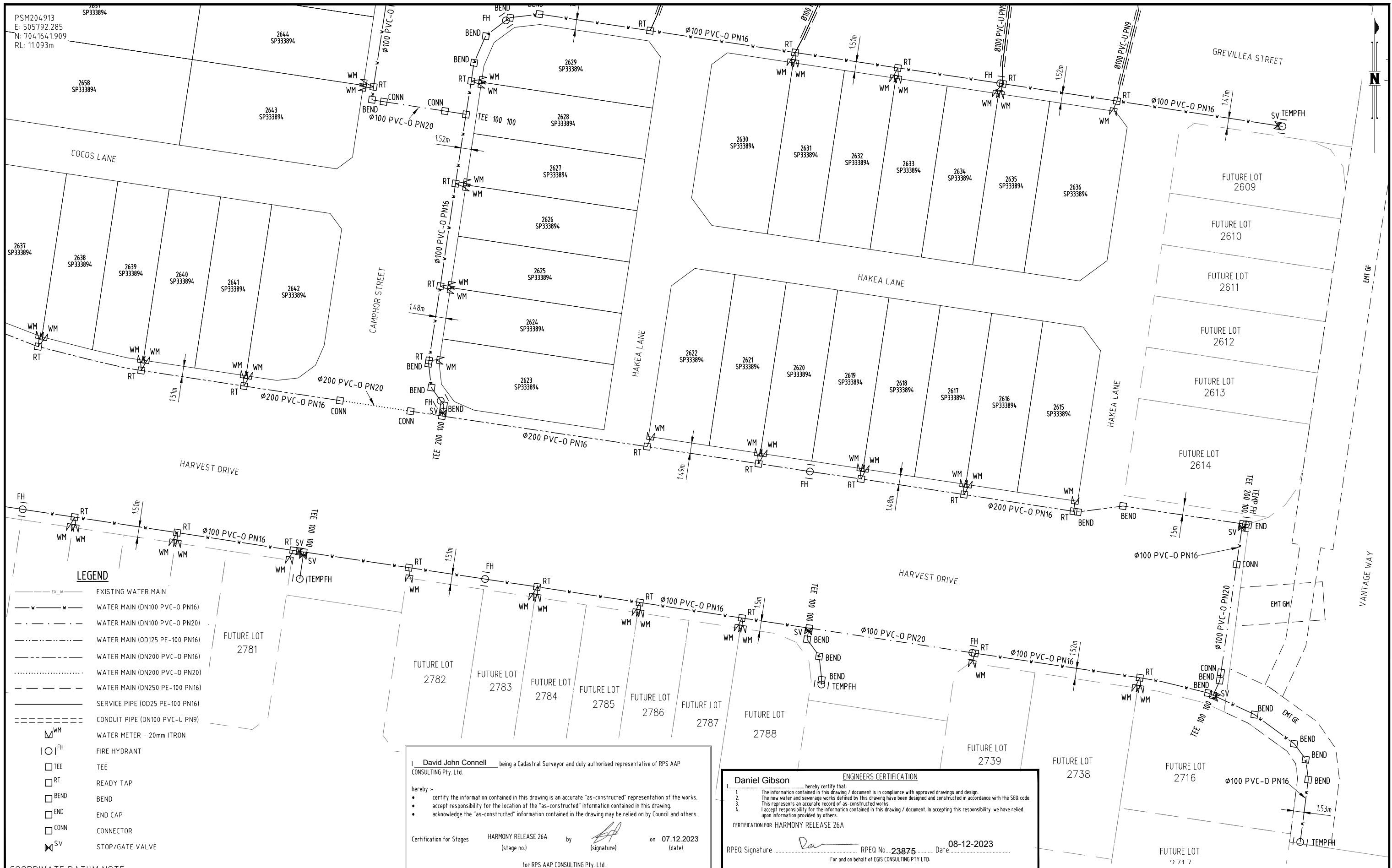

**LEGEND**

- EX\_W — EXISTING WATER MAIN
- WATER MAIN (DN100 PVC-O PN16)
- WATER MAIN (DN100 PVC-O PN20)
- WATER MAIN (OD125 PE-100 PN16)
- WATER MAIN (DN200 PVC-O PN16)
- WATER MAIN (DN200 PVC-O PN20)
- WATER MAIN (DN250 PE-100 PN16)
- SERVICE PIPE (OD25 PE-100 PN16)
- CONDUIT PIPE (DN100 PVC-U PN9)
- WM WATER METER - 20mm ITRON
- FH FIRE HYDRANT
- TEE TEE
- RT READY TAP
- BEND BEND
- END END CAP
- CONN CONNECTOR
- SV STOP/GATE VALVE

**COORDINATE DATUM NOTE:**  
 HORIZONTAL COORDINATES(E,N) SUPPLIED ARE MAPPING GRID OF AUSTRALIA(MGA), ZONE 56 BASED ON THE UNIVERSAL TRANSVERSE MERCATOR PROJECTION AND THE GEOCENTRIC DATUM OF AUSTRALIA 1994.

I, **David John Connell** being a Cadastral Surveyor and duly authorised representative of RPS AAP CONSULTING Pty. Ltd.  
 hereby --  
 • certify the information contained in this drawing is an accurate "as-constructed" representation of the works.  
 • accept responsibility for the location of the "as-constructed" information contained in this drawing.  
 • acknowledge the "as-constructed" information contained in the drawing may be relied on by Council and others.  
 Certification for Stages HARMONY RELEASE 26A by *[Signature]* on 07.12.2023 (stage no.) (signature) (date)  
 for RPS AAP CONSULTING Pty. Ltd.

**Daniel Gibson** ENGINEERS CERTIFICATION  
 hereby certify that:  
 1. The information contained in this drawing / document is in compliance with approved drawings and design.  
 2. The new water and sewerage works defined by this drawing have been designed and constructed in accordance with the SEQ code.  
 3. This represents an accurate record of as-constructed works.  
 4. I accept responsibility for the information contained in this drawing / document. In accepting this responsibility we have relied upon information provided by others.  
 CERTIFICATION FOR HARMONY RELEASE 26A  
 RPEQ Signature *[Signature]* RPEQ No. **23875** Date **08-12-2023**  
 For and on behalf of EGIS CONSULTING PTY LTD.

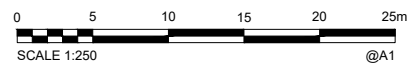

**AS CONSTRUCTED**

A1	0	31/10/2023	AS CONSTRUCTED DETAILS	LG	BS	PASSED
	INDEX	DATE	REVISIONS	DRAWN	CHECKED	PASSED

DRAWN	LG	31/10/2023
CHECKED	BS	31/10/2023
PASSED		
INITIALS	DATE	



EGIS CONSULTING Pty Ltd  
 Level 4, Unit 401, 8 Market Lane,  
 Maroochydore, QLD 4558  
 Telephone 07 5314 2520  
 Facsimile 07 5314 2522



**Unitywater**  
 202202168952  
 HARMONY RELEASE 26A  
 AS CONSTRUCTED  
 WATER SUPPLY

SHEET 5 OF 10 SHEETS	SCALE 1:250
REVISION DATE 31/10/2023	REVISION 0
DISCIPLINE CODE C	
DRAWING NO. U-2023-4830	

PSM204.913  
E: 505792.285  
N: 704164.1909  
RL: 11.093m

SUGAR MILL ROAD

LEGEND

- MAINTENANCE SHAFT (Ø600 LMDPE SMARTSTREAM POOPIT ON Ø300 UPVC RISER)
- MAINTENANCE HOLE (Ø1050 INSITU CONCRETE)
- MAINTENANCE HOLE (Ø1200 INSITU CONCRETE)
- EXISTING MAINTENANCE HOLE
- BEND
- WYE
- RETICULATION MAIN (DN150 PVC-U SN8)
- RETICULATION MAIN (DN150 PVC-U 12)
- HOUSE CONNECTION (ØD100 PVC-U SN8)
- EXISTING SEWER MAIN

David John Connell being a Cadastral Surveyor and duly authorised representative of RPS AAP CONSULTING Pty. Ltd.

hereby :-

- certify the information contained in this drawing is an accurate "as-constructed" representation of the works.
- accept responsibility for the location of the "as-constructed" information contained in this drawing.
- acknowledge the "as-constructed" information contained in the drawing may be relied on by Council and others.

Certification for Stages HARMONY RELEASE 26A by on 07.12.2023  
(stage no.) (signature) (date)

for RPS AAP CONSULTING Pty. Ltd.

Daniel Gibson ENGINEERS CERTIFICATION

- I hereby certify that:
1. The information contained in this drawing / document is in compliance with approved drawings and design.
  2. The new water and sewerage works defined by this drawing have been designed and constructed in accordance with the SED code.
  3. This represents an accurate record of as-constructed works.
  4. I accept responsibility for the information contained in this drawing / document. In accepting this responsibility we have relied upon information provided by others.

CERTIFICATION FOR HARMONY RELEASE 26A

RPEQ Signature RPEQ No. 23875 Date 08-12-2023

For and on behalf of EGIS CONSULTING PTY LTD.

5  
SP333894

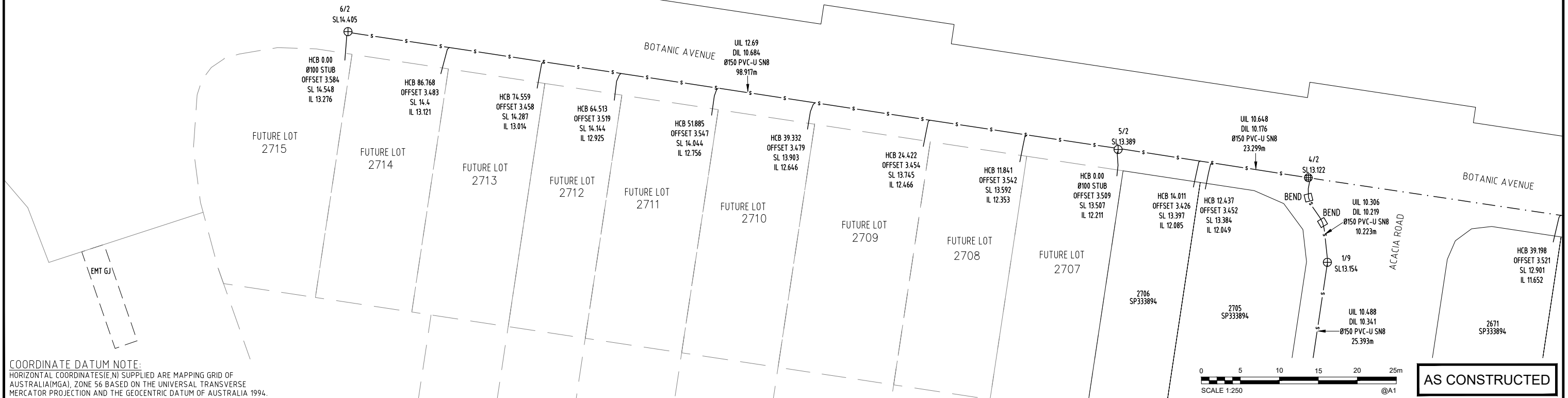

COORDINATE DATUM NOTE:  
HORIZONTAL COORDINATES(E,N) SUPPLIED ARE MAPPING GRID OF AUSTRALIA(MGA), ZONE 56 BASED ON THE UNIVERSAL TRANSVERSE MERCATOR PROJECTION AND THE GEOCENTRIC DATUM OF AUSTRALIA 1994.

0 5 10 15 20 25m  
SCALE 1:250 @A1

AS CONSTRUCTED

A1

INDEX	DATE	REVISIONS	DRAWN	CHECKED	PASSED
0	31/10/2023	AS CONSTRUCTED DETAILS	LG	BS	

DRAWN	LG	31/10/2023
CHECKED	BS	31/10/2023
PASSED		
INITIALS		DATE



Unitywater

202202168952  
HARMONY RELEASE 26A  
AS CONSTRUCTED  
SEWERAGE RETICULATION

SHEET	6 OF 10 SHEETS	SCALE	1:250
REVISION DATE	31/10/2023	REVISION	0
DISCIPLINE CODE	C		
DRAWING NO.	U-2023-4830		



PSM204913  
E: 505792.285  
N: 704164.1909  
RL: 11.093m

**LEGEND**

- MAINTENANCE SHAFT (Ø600 LMDPE SMARTSTREAM POOPIT ON Ø300 UPVC RISER)
- MAINTENANCE HOLE (Ø1050 INSITU CONCRETE)
- MAINTENANCE HOLE (Ø1200 INSITU CONCRETE)
- EXISTING MAINTENANCE HOLE
- BEND
- WYE
- WYE JUNCTION (OD160xOD160 WITH OD160xOD110 REDUCER)
- RETICULATION MAIN (DN150 PVC-U SN8)
- RETICULATION MAIN (DN150 PVC-U 12)
- HOUSE CONNECTION (OD100 PVC-U SN8)
- EXISTING SEWER MAIN

**Daniel Gibson** ENGINEERS CERTIFICATION  
I hereby certify that:  
1. The information contained in this drawing / document is in compliance with approved drawings and design.  
2. The new water and sewerage works defined by this drawing have been designed and constructed in accordance with the SEQ code.  
3. This represents an accurate record of as-constructed works.  
4. I accept responsibility for the information contained in this drawing / document. In accepting this responsibility we have relied upon information provided by others.

CERTIFICATION FOR HARMONY RELEASE 26A  
RPEQ Signature: *[Signature]* RPEQ No. 23875 Date: 08-12-2023  
For and on behalf of EGIS CONSULTING PTY LTD.

**David John Connell** being a Cadastral Surveyor and duly authorised representative of RPS AAP CONSULTING Pty. Ltd.  
hereby:-  
• certify the information contained in this drawing is an accurate "as-constructed" representation of the works.  
• accept responsibility for the location of the "as-constructed" information contained in this drawing.  
• acknowledge the "as-constructed" information contained in the drawing may be relied on by Council and others.

Certification for Stages HARMONY RELEASE 26A by *[Signature]* on 07.12.2023 (stage no.) (signature) (date)  
for RPS AAP CONSULTING Pty. Ltd.

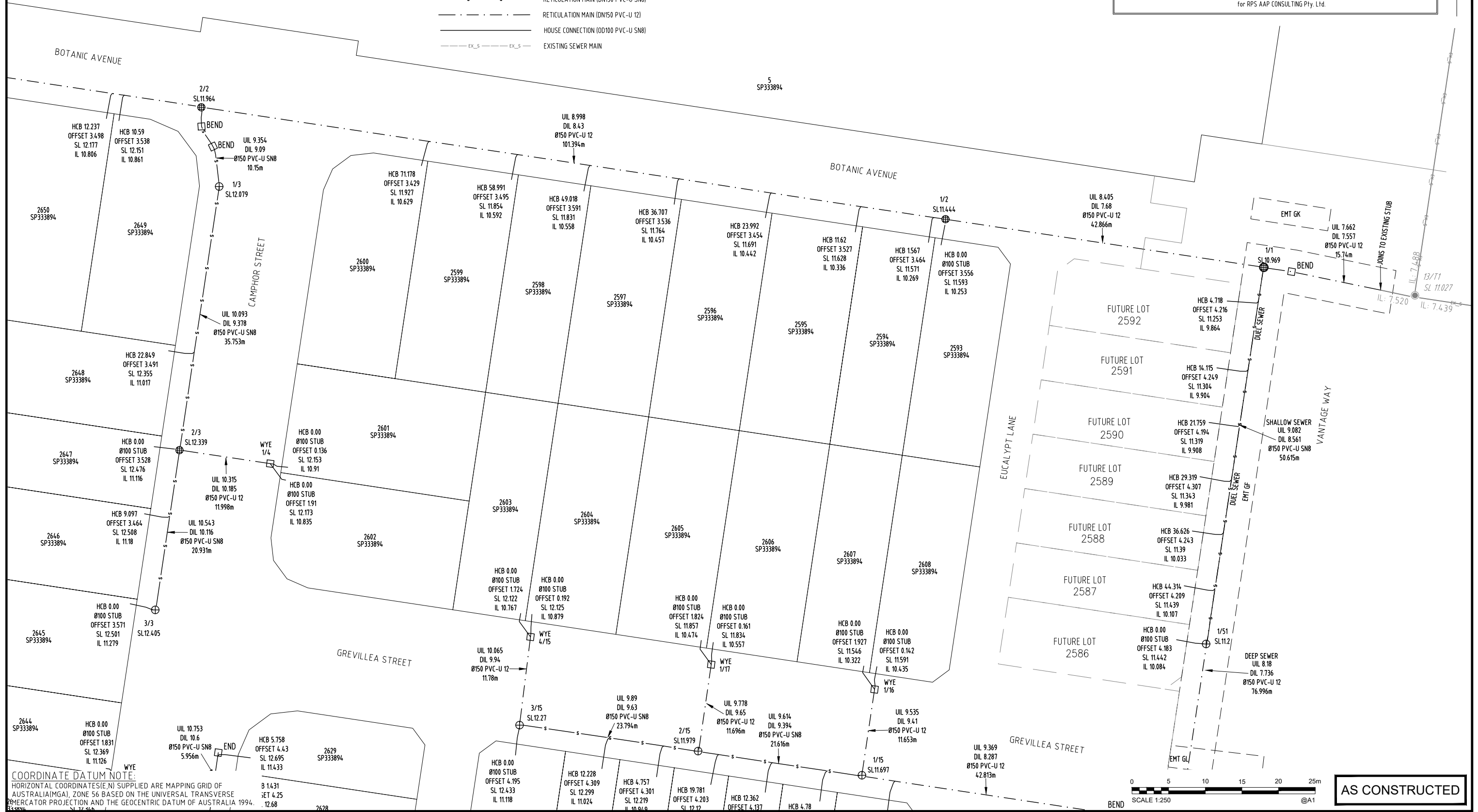

**COORDINATE DATUM NOTE:**  
HORIZONTAL COORDINATES (E, N) SUPPLIED ARE MAPPING GRID OF AUSTRALIA (MGA), ZONE 56 BASED ON THE UNIVERSAL TRANSVERSE MERCATOR PROJECTION AND THE GEOCENTRIC DATUM OF AUSTRALIA 1994.

SCALE 1:250 @A1  
**AS CONSTRUCTED**

A1	0	31/10/2023	AS CONSTRUCTED DETAILS	LG	BS	
	INDEX	DATE	REVISIONS	DRAWN	CHECKED	PASSED

DRAWN	LG	31/10/2023
CHECKED	BS	31/10/2023
PASSED		
INITIALS	DATE	

EGIS CONSULTING Pty Ltd  
Level 4, Unit 401, 8 Market Lane,  
Maroochydore, QLD 4558  
Telephone 07 5314 2520  
Facsimile 07 5314 2522

Unitywater

**Unitywater**  
202202168952  
HARMONY RELEASE 26A  
AS CONSTRUCTED  
SEWERAGE RETICULATION

SHEET 8 OF 10 SHEETS	SCALE 1:250
REVISION DATE 31/10/2023	REVISION 0
DISCIPLINE CODE C	
DRAWING NO. U-2023-4830	





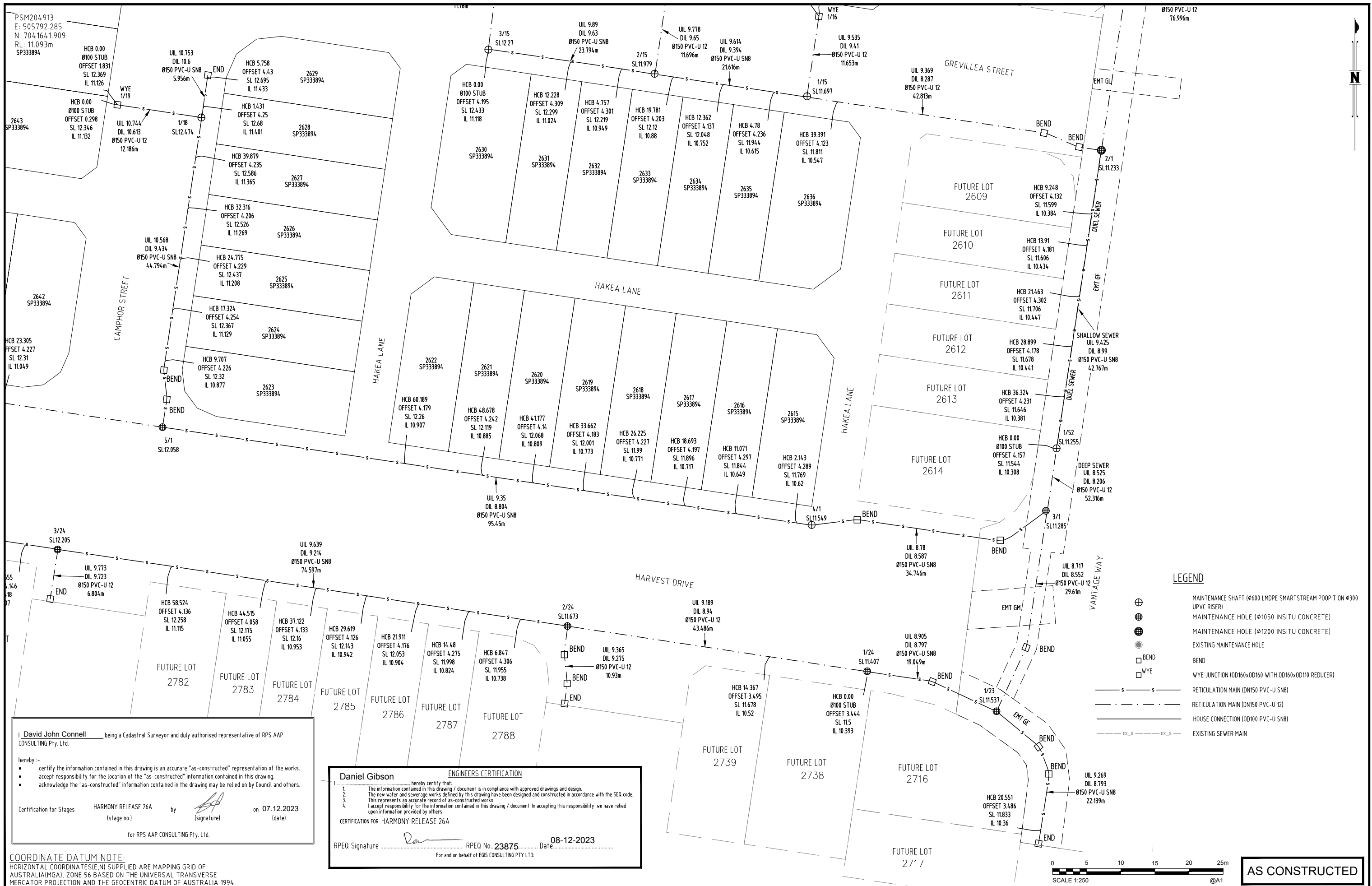

- LEGEND**
- ⊕ MAINTENANCE SHAFT (Ø600 LMDPE SMARTSTREAM POOPIT ON Ø300 UPVC RISER)
  - ⊗ MAINTENANCE HOLE (Ø1050 INSITU CONCRETE)
  - ⊙ MAINTENANCE HOLE (Ø1200 INSITU CONCRETE)
  - ⊘ EXISTING MAINTENANCE HOLE
  - ⊞ BEND
  - ⊞ WYE
  - ⊞ WYE JUNCTION (ØD160xØD160 WITH ØD160xØD110 REDUCER)
  - RETICULATION MAIN (DN150 PVC-U SN8)
  - - - RETICULATION MAIN (DN150 PVC-U 12)
  - HOUSE CONNECTION (ØD100 PVC-U SN8)
  - - - EX\_S - - - EX\_S - - - EXISTING SEWER MAIN

I **David John Connell** being a Cadastral Surveyor and duly authorised representative of RPS AAP CONSULTING Pty. Ltd.

hereby :-

- certify the information contained in this drawing is an accurate "as-constructed" representation of the works.
- accept responsibility for the location of the "as-constructed" information contained in this drawing.
- acknowledge the "as-constructed" information contained in the drawing may be relied on by Council and others.

Certification for Stages **HARMONY RELEASE 26A** (stage no.) by  (signature) on **07.12.2023** (date)

for RPS AAP CONSULTING Pty. Ltd.

**Daniel Gibson** ENGINEERS CERTIFICATION

I hereby certify that:

1. The information contained in this drawing / document is in compliance with approved drawings and design.
2. The new water and sewerage works defined by this drawing have been designed and constructed in accordance with the SED code.
3. This represents an accurate record of as-constructed works.
4. I accept responsibility for the information contained in this drawing / document. In accepting this responsibility we have relied upon information provided by others.

CERTIFICATION FOR HARMONY RELEASE 26A

RPEQ Signature  RPEQ No. **23875** Date **08-12-2023**

For and on behalf of EGIS CONSULTING PTY LTD.

**COORDINATE DATUM NOTE:**  
 HORIZONTAL COORDINATES(E,N) SUPPLIED ARE MAPPING GRID OF AUSTRALIA(MGA), ZONE 56 BASED ON THE UNIVERSAL TRANSVERSE MERCATOR PROJECTION AND THE GEOCENTRIC DATUM OF AUSTRALIA 1994.

SCALE 1:250 @A1

**AS CONSTRUCTED**

<b>A1</b>	0	31/10/2023	AS CONSTRUCTED DETAILS	LG	BS	PASSED
	INDEX	DATE	REVISIONS	DRAWN	CHECKED	PASSED

DRAWN	LG	31/10/2023
CHECKED	BS	31/10/2023
PASSED		
INITIALS	DATE	



**Unitywater**

2022021689S2  
 HARMONY RELEASE 26A  
 AS CONSTRUCTED  
 SEWERAGE RETICULATION

SHEET 10 OF 10 SHEETS	SCALE 1:250
REVISION DATE 31/10/2023	REVISION 0
DISCIPLINE CODE C	
DRAWING NO. U-2023-4830	